

Etruria Valley Link Road Consultation

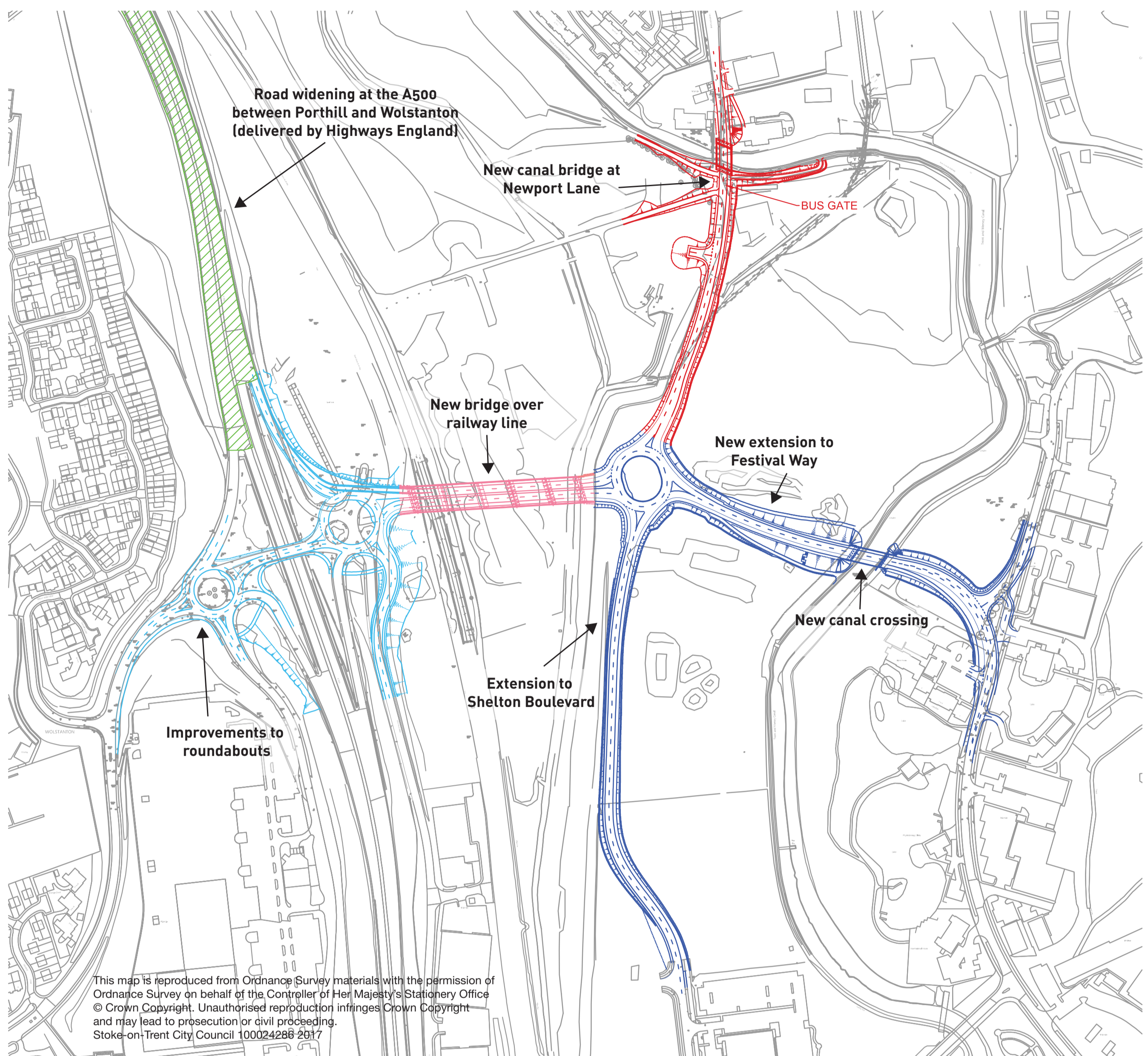

The Etruria Valley Link Road consists of four distinct parts:

Section 1A

Construction of a new road to connect Festival Way and Shelton Boulevard, including a central roundabout, a bridge across the Trent and Mersey Canal and a footpath link to the Trent and Mersey Canal.

Section 1B

The continuation of Shelton Boulevard to Newport Lane including a new bridge over the Trent and Mersey Canal. There will be a bus gate restricting traffic on this new section of Newport Lane to Public Transport, pedestrians and cyclists only. This section of works also includes a new pedestrian link leading down to the Trent and Mersey canal.

Section 2

Construction of a road bridge crossing to link Sections 1A and 1B to the A500. This bridge will cross the West Coast Main line railway and Fowlea Brook.

Section 3

Improvement to the existing two roundabouts on the A500/Wolstanton junction providing a connection between the A500 and A527 and forming the connection point for the Section 2 works.

Section 4

Road widening at the A500 between Porthill and Wolstanton (delivered by Highways England)



City of
Stoke-on-Trent